

Tudor Plaza

Unique 1,833 sq. ft. Office Suite Available
for Immediate Occupancy



4105 North 20th Street, Phoenix, AZ 85016

- Fully built-out suite comprises entire second floor of octagonal-shaped, elevator-served building
- Attractive, fully landscaped complex features interior courtyard with fountain
- Abundant visitor and tenant parking
- Located 1/2 mile off SR 51, within 5 minutes of Camelback Esplanade, and only 10 minutes from downtown and Sky Harbor International Airport

PRICED AT \$175 PER SQUARE FOOT

For additional information, contact: **Barry Rosensteel**
PRIN Investments Real Estate Group • 602.840.1003
Barry.Rosensteel@prinreg.com

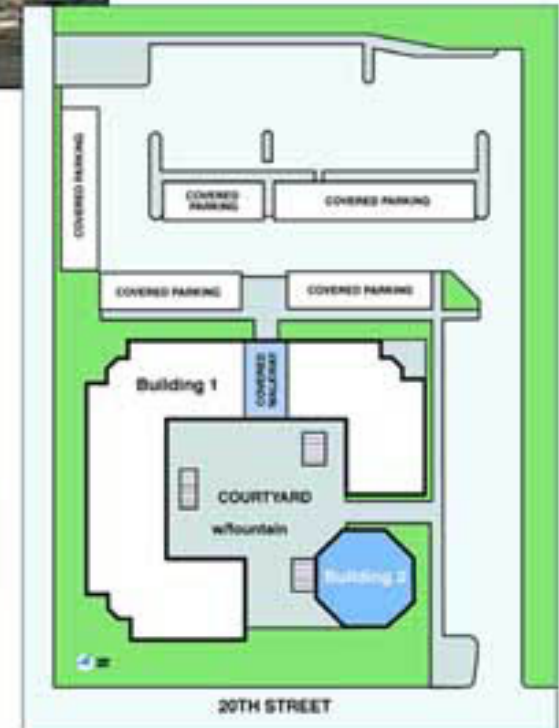

PRIN
INVESTMENTS
Real Estate Group

Tudor Plaza

4105 North 20th Street, Phoenix, AZ 85016

Unique 1,833 sq. ft. Office
Suite Available
for Immediate Occupancy

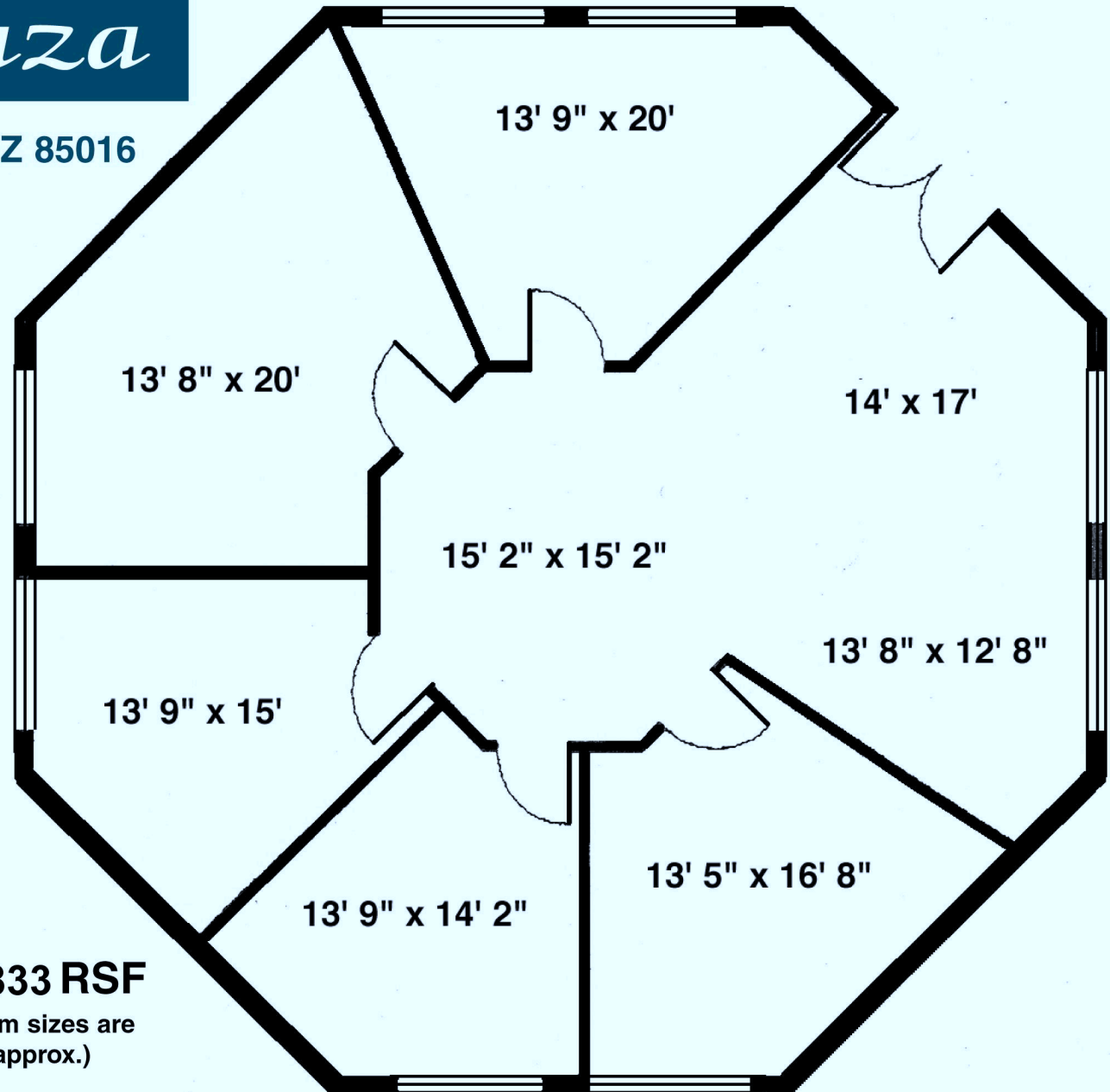
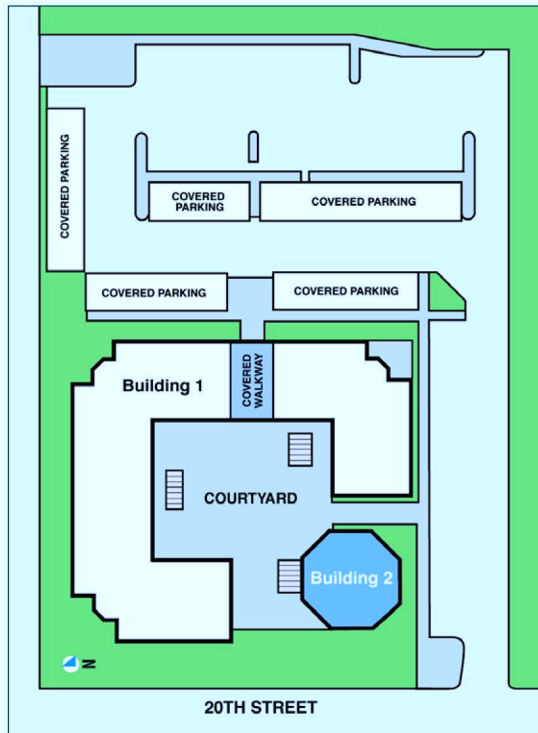

1,833 RSF
(room sizes are
approx.)

PRIN
INVESTMENTS
Real Estate Group

For additional information, contact: **Barry Rosensteel**
PRIN Investments Real Estate Group • 602.840.1003
Barry.Rosensteel@prinreg.com